

*Investigation on air quality of specific
indoor environments—spa salons located in
Gdynia, Poland*

**Klaudia Pytel, Renata Marcinkowska &
Bożena Zabiegała**

**Environmental Science and Pollution
Research**

ISSN 0944-1344

Environ Sci Pollut Res
DOI 10.1007/s11356-020-09860-4



Your article is published under the Creative Commons Attribution license which allows users to read, copy, distribute and make derivative works, as long as the author of the original work is cited. You may self-archive this article on your own website, an institutional repository or funder's repository and make it publicly available immediately.





Investigation on air quality of specific indoor environments—spa salons located in Gdynia, Poland

Klaudia Pytel¹ · Renata Marcinkowska¹ · Bożena Zabiegała¹

Received: 28 November 2019 / Accepted: 22 June 2020
© The Author(s) 2020

Abstract

Due to excessive application of essential oils and scented products in spa salons during aromatherapy and massage sessions, the elevated concentration of total volatile organic compounds (TVOCs), particularly terpenes, which are known as secondary organic aerosol (SOA) precursors, is expected there. This study was aimed at determination of VOCs with a particular regard to terpenes in air samples collected in selected spa salons located in Northern Poland. Active air sampling was conducted before and after treatments. Samples were analyzed with the use of thermal desorption gas chromatography coupled with flame-ionization detector (TD-GC-FID) and mass spectrometer (TD-GC-MS). Obtained results allowed to characterize chemical composition of indoor air of spa salons and also to relate the dependence between applied essential oil and indoor air chemical composition. It has been proved that (i) spa salons are characterized by TVOC concentrations exceeding recommended values of 300–400 $\mu\text{g m}^{-3}$ in most of examined cases, reaching up to several thousand of micrograms per cubic meter, (ii) TVOC concentration is strictly related to salon characteristics and carried out treatments, (iii) terpenes constitute a significant part of TVOCs present in spa indoor air, from 22 up to 86%, (iv) most commonly investigated terpenes in the literature (D-limonene, α -pinene, camphene, and linalool) were also determined at the highest concentration levels in this study and (v) VOC chemical composition is strictly dependent on the type of applied essential oils. On the basis of obtained results, it may be stated that extensive application of essential oils rich in terpenes can significantly alter indoor air chemistry of spa salons, thereby influencing health and well-being of employees working there.

Keywords Indoor air · Indoor air quality · Volatile organic compounds · Terpenes · Spa salons · Aromatherapy · Essential oils

Introduction

For several decades, indoor air quality has been a matter of interest of both scientists and politicians. This was triggered by the fact that people may spend up to even 90% of their time indoors, and therefore, chemical and physical transformations which occur indoors (sometimes referred as “indoor chemistry”) appeared as greatly important to human health and well-being (Samet 1993; Weschler and Carslaw 2018). Intensified interest in studying indoor air was triggered by proving that

referring already gained knowledge of atmospheric air to indoor air may lead to inconsistencies, since mechanisms which govern indoor air chemistry are different from those characteristic to atmospheric air. Also, there are significant differences between these two environments in abundance of defined components and direct sunlight, temperature, and humidity fluctuations etc. (Weschler and Carslaw 2018; Abbatt and Chen 2020).

Indoor air chemistry is greatly affected by primary emission of volatile organic compounds (VOCs) from a wide range of sources present indoors, i.e., furnishing, building materials, everyday use products, human activities, and humans themselves (e.g., squalene, acetone) (Haghighat and De Bellis 1998; Klein et al. 2016; Lakey et al. 2017). Elevated VOC concentrations in indoor air pose a threat to human health, since a lot of VOCs (e.g., aldehydes, aromatics) (Liu et al. 2019) are documented to cause adverse health effects such as asthma and allergic reactions (Sofuoglu et al. 2011), as well as damage of the liver, kidneys, and nervous system.

Responsible Editor: Constantini Samara

✉ Renata Marcinkowska
renata.marcinkowska@pg.edu.pl

¹ Department of Analytical Chemistry, Faculty of Chemistry, Gdańsk University of Technology, G. Narutowicza 11/12 Str., 80-233 Gdańsk, Poland

Moreover, some VOCs may exhibit a carcinogenic activity resulting in lung, brain, liver, blood, and kidney cancer (Rumchev et al. 2007).

Among VOCs, terpenes are a group of significant importance, since terpene-rich essential oils are components of used indoor furnishing, cleaning, fragrance, cosmetic, and cooking products. In addition, terpenes may be emitted also from natural sources such as plants and citrus fruits; however, it is believed that anthropogenic sources are those mostly responsible for elevated concentration of terpenes indoors (Wolkoff et al. 2000; Nazaroff and Weschler 2004; Tsigonia et al. 2010). Terpenes with one or more double bonding in their structure are highly reactive; hence, they instantly and easily undergo oxidation processes in indoor air such as ozonolysis (Weschler 2000; Atkinson and Arey 2003). Terpene ozonolysis initiates a number of chemical transformations, which lead to the formation of secondary organic aerosol (SOA) composition, especially in the first phase of rising, of nanosized (submicron) particles. These particles have been proved to pose a threat for human health (Rösch et al. 2017) since they are able to enter respiratory track and deposit along it by few mechanisms: diffusion, sedimentation, and impaction (Dockery et al. 1993; Spengler et al. 1996; Yeh et al. 1996; Pope and Dockery 2006). It has been proved that inhalation of SOA can cause some serious health effects such as inflammatory response in body tissues (Anderson et al. 2013), changes in lung cells, breath frequency decrease (Clausen et al. 2001; Sunil et al. 2007; Wolkoff et al. 2008, 2012), eye-blink frequency increase (Klenø and Wolkoff 2004; Nøjgaard et al. 2005), and even cancer (Pope and Dockery 2006).

There is a wide range of research carried out to determine VOC concentration with emphasis on terpenes in various indoor environments, e.g., homes (Król et al. 2014; Mickaël et al. 2014; Schlink et al. 2016), offices (Su et al. 2007; Dudzinska et al. 2012; Katsoyiannis et al. 2014), and schools (Larroque et al. 2006; Pegas et al. 2011; Markowicz and Larsson 2015). However, there is a limited number of research focusing on specific kind of indoor environments, where terpinene concentration is expected to be elevated, such as wineries (Sanjuán-Herráez et al. 2014), treatment plants (Gallego et al. 2012), elderly homes (Walgraeve et al. 2011), and beauty salons (Tsigonia et al. 2010).

Terpene-rich essential oils are widely applied as therapeutic agents during aromatherapy sessions known as alternative method of treatment. There are three main models of aromatherapy treatment: medical, where essential oils are most commonly delivered inside the body (oral, rectal, vaginal way); subtle aromatherapy, where essential oils are most commonly inhaled; and traditional aromatherapy, which is based on massage with essential oils (Dunning 2013). Aromatherapy is an area of growing interest, which becomes popular for example in psychiatry and oncology (da Silva Domingos and Braga 2014). Aromatherapy massages are very willingly used for

relaxation; therefore, more and more people are inclined to undergo it (Grand View Research 2019).

Since terpenes are the main components of essential oils (Bakkali et al. 2008), a significant quantities of them are expected to be emitted into indoor air of spa salons during aromatherapy sessions. Since customers of spa salons usually spent there ca. 1 h, it can be assumed that exposition to elevated total volatile organic compounds (TVOCs) and terpene oxidation product concentration would not strongly affect clients' health and well-being. Therefore, visiting spa for relaxation or taking physio- or aromatherapy session may actually be beneficial. However, employees of spa salons, by spending whole working day—usually 8 h—in spa indoor air may be exposed to elevated TVOCs and terpene oxidation product concentration, which may affect their health and well-being.

Worldwide, studies in this research area are focused most commonly on the determination of the composition either of the essential oil or the volatile fraction emitted from essential oil (or scented candles) that are usually applied in aromatherapy. Such studies are typically carried out with the application of a reaction chamber that mimics indoor air conditions, by direct GC analysis of essential oil solutions or with the use of SPME-based methodologies (Chiu et al. 2009; Huang et al. 2011; Cheng and Lai 2014; Ahn et al. 2015; Nematollahi et al. 2018). The aim of this research was to expand the knowledge and awareness related to temporary and permanent residence in indoor environments of specific types. Investigating indoor air quality in spa salons, where traditional aromatherapy session took place and, therefore, enhanced terpene evaporation into indoor air is expected, delivers valuable data useful for better understanding of indoor air chemistry. The main goal of this study was to determine the concentration of terpenes detected in indoor air samples in spa salons and to correlate carried out treatments and applied essential oils and cosmetic products with the chemical composition of indoor air. In the available literature, there are very few reported studies, in which sampling was carried out in real spa indoor environments, e.g., located in Taiwan (Hsu et al. 2012; Huang et al. 2012); however, a major emphasis has been put on SOA formation. To the best of our knowledge, this is the first study focused on VOC (with particular emphasis on terpenes) determination in such specific environments carried out in Poland.

Materials and methods

Sampling sites

Four spa salons located in Gdynia (Poland) City center were chosen as sampling sites. Sampling campaign lasted from January 2019 to April 2019, and the sum of 60 samples was collected during campaign. Forty-four of them were analyzed with an application of thermal desorption and gas

chromatography with flame-ionization detector (TD-GC-FID), and 16 of them were analyzed by thermal desorption and gas chromatography with mass spectrometry (TD-GC-MS). The brief characteristics of sampling sites together with schematic representation of their space arrangement (see Fig. 1) are presented below.

- Spa salon 1—typical spa salon, in which main treatments are aromatherapy massages with an application of large amounts of essential oils and body butters. Salons offers also esthetic medicine treatments and manicure, but those services are done in other rooms. Usually, clients are served during all day, which results in over a dozen of clients per day. For sampling, 4 and 13 samples were collected before and after treatment, respectively;
- Spa salon 2—massage center, in which relaxing aromatherapy massages and physiotherapy massages are carried out. This salon mostly serves regular customers, and visits are planned for whole day; therefore, over a dozen of clients is served daily. For sampling, 2 and 16 samples were collected before and after treatment, respectively;
- Spa salon 3—city spa which proposes few relaxing treatments: sensory deprivation, ganbanyouku, and ayurvedic massages. Massage room is equipped with two heated beds dedicated for ayurvedic massages. Spa 3 offers other treatments than massages; therefore, amount of daily performed massages is not regular and hard to define. It is common that number of massage clients rises due to periodic circumstances, e.g., Valentine’s day. For sampling, 5

and 14 samples were collected before and after treatment, respectively;

- Spa salon 4—health and beauty studio which is specialized in physiotherapy massages, which do not require application of fragrance compounds. Relaxing massages with essential oils are performed rarely. For sampling, 2 and 4 samples were collected before and after treatment, respectively. Limited number of samples is due to salon characteristics.

Sampling

Air samples were collected before and after massage sessions (each session lasted 1 h). As sampling sorbent, Tenax TA® (Tenax TA 35/60®, 100 g, hydrophobic) was selected (Arrhenius and Engelbrektsson 2016; Petr and Soukupová 2017; Ramos et al. 2018; SIS 2019). Before sampling and after each analysis, sorbent tubes were conditioned for 6 h, at temperature of 300 °C in inert gas atmosphere using thermal desorption unit (Markes® Unity, Markes International, Great Britain). Conditioning was followed by a blank gas chromatography run (Agilent 7820A, Agilent Technologies Inc., USA with FID detector) to ensure no carry over effect. After conditioning, sorbent tubes were sealed with two-piece brass storage caps filled with one-piece PTFE ferrules (6 mm i.d.) and additionally closed in a screw cap glass vials for storage and transport. Samples were actively sampled via gas-tight

Fig. 1 Schematic representation of room space arrangement of each of chosen spa salon

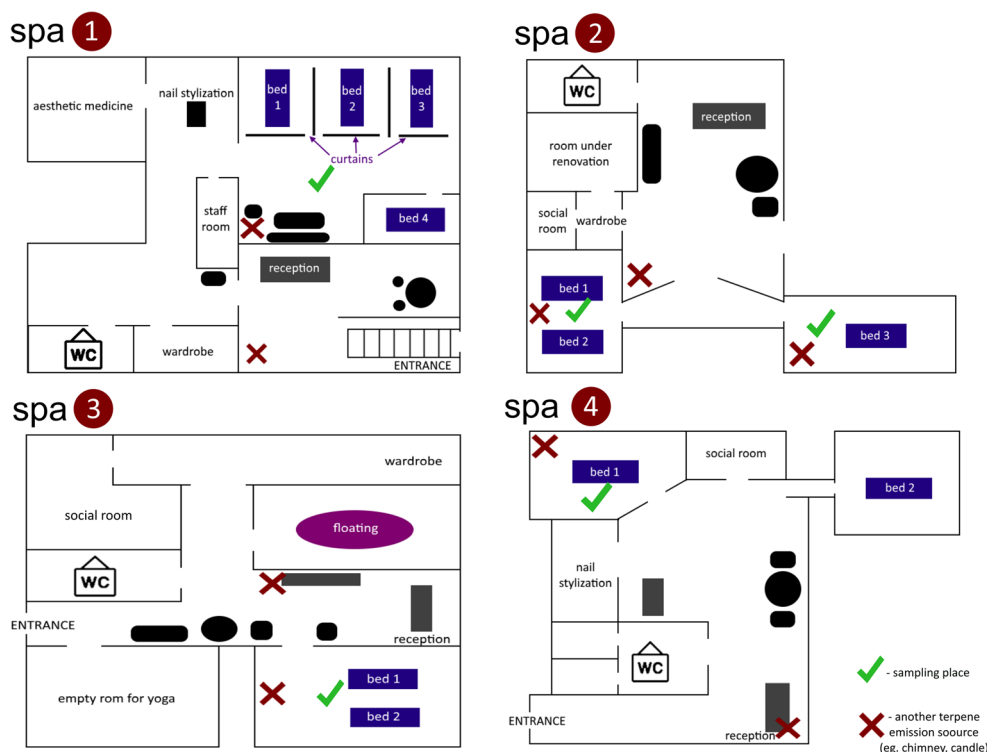

syringe or automatic pump (constructed at Gdańsk University of Technology especially for the purpose of this study with constant air flow of 120 ml min^{-1}). During sampling, 1 l or 2 l of air (depending on the carried out treatment) was actively passed through the sorbent tubes. During each sampling, there was one blank sorbent tube, which was sealed and placed near the sampling spot. Blank tube was maintained and handled the same way as sorbent tubes used for sampling. After sampling, sorbent tubes were sealed in the same way as described above. All samples were stored in a temperature not exceeding $20 \text{ }^\circ\text{C}$, hidden from the sunlight, and were analyzed during max. of 48 h since sampling.

Analytes of interest

The main goal of this work was to focus on determination of terpenes present in spa indoor air at high concentration levels; therefore, the main emphasis has been put on α -pinene, D-limonene, camphene, and linalool. Other VOC characteristics for each spa indoor environment, determined in this study qualitatively and quantitatively, are listed in Appendix Tables 2, 3, 4, 5, and 6. They represent such groups of chemical compounds as follows: alcohols, organic acids, esters, aldehydes, alkenes, alkanes, siloxanes, ketones, and terpene oxides.

Chromatographic analysis and calibration

To carry out qualitative analysis, samples were subjected to thermal desorption (Markes® Unity, Markes International, Great Britain) and further to gas chromatography (Agilent 6890, Agilent Technologies Inc., USA) coupled with mass spectrometry (Agilent 5973 Mass Selective Detector, Agilent Technologies Inc., USA) (TD-GC-MS). Analytes were separated on DB-1 capillary column (Agilent Technologies; $60 \text{ m} \times 0.25 \text{ mm} \times 1 \text{ }\mu\text{m}$; 100% polydimethylsiloxane). To carry out quantitative analysis, samples were subjected to thermal desorption (Markes® Unity 2, Markes International, Great Britain) and further to gas chromatography (Agilent 7820A, Agilent Technologies Inc., USA) equipped with flame-ionization detector (TD-GC-FID). Analytes were separated on DB-1 capillary column (Agilent Technologies; $30 \text{ m} \times 0.32 \text{ mm} \times 5 \text{ }\mu\text{m}$; 100% polydimethylsiloxane). In both cases, chromatographic analysis was preceded with 10-min thermal desorption under $290 \text{ }^\circ\text{C}$ which was followed by transportation of desorbed analytes in the He stream (45 mL min^{-1}) to the microtrap cooled down to $0 \text{ }^\circ\text{C}$ and subsequent heating of the microtrap to $300 \text{ }^\circ\text{C}$ for 5 min in order to release the analytes and direct them to chromatographic column. Temperature program of the GC-MS analysis was as follows: $50 \text{ }^\circ\text{C}$, $10 \text{ }^\circ\text{C/min}$ to $280 \text{ }^\circ\text{C}$. Temperature of ion source was $250 \text{ }^\circ\text{C}$, while temperature of quadrupole was $150 \text{ }^\circ\text{C}$. Temperature program of the GC-FID analysis was as

follows: $40 \text{ }^\circ\text{C}$ for 10 min, $10 \text{ }^\circ\text{C/min}$ to $125 \text{ }^\circ\text{C}$, $15 \text{ }^\circ\text{C/min}$ to $240 \text{ }^\circ\text{C}$ held for 5 min. Detector temperature was $250 \text{ }^\circ\text{C}$.

For monoterpene concentration determination, five-point calibration curve was created using limonene ((R)-(+)-limonene standard, 97% purity, (Sigma-Aldrich, Poland) dissolved in methanol (gradient grade for liquid chromatography 99.9% purity, Merck) calibration solutions of following concentrations: 2.0; 4.0; 6.0; 8.0; and $10.0 \text{ ng }\mu\text{L}^{-1}$. For each concentration $1 \text{ }\mu\text{L}$ of calibration solution was introduced on previously conditioned sorbent tube, which was then flushed by a stream of nitrogen (99.999% purity) for 4 min. Afterwards, sorbent tube was sealed with two-piece brass storage caps, closed in a screw cap glass vials and quickly (up to 1 min) analyzed by TD-GC-FID. Each calibration solution was analyzed by TD-GC-FID in at least 3 repetitions. In order to obtain the best possible match, first two points of calibration curve were used to calculate LOD and LOQ values. For limonene $\text{LOD} = 0.7 \text{ ng}$, $\text{LOQ} = 2 \text{ ng}$ which after recounting per 2-l air samples resulted in $\text{LOD} = 0.35 \text{ }\mu\text{g m}^{-3}$ (0.063 ppbv) and $\text{LOQ} = 1 \text{ }\mu\text{g m}^{-3}$ (0.18 ppbv). Percentage standard uncertainty associated with application of determined calibration relationship was calculated using Formula (1), (2), and (3). For limonene, percentage uncertainty is equal to 5.5%.

$$u(x_{\text{pr}})\% = \frac{u(x_{\text{pr}})}{x_{\text{pr}}} \quad (1)$$

where:

x_{pr} —analyte content (half of calibration curve)

$u(x_{\text{pr}})$ —standard uncertainty

$$u(x_{\text{pr}}) = \frac{S_{x,y}}{b} \times \sqrt{\frac{1}{p} + \frac{1}{n} + \frac{(x_{\text{pr}} - \bar{x})^2}{Q_{xx}}} \quad (2)$$

where:

$S_{x,y}$ —standard deviation

b —slope

p —number of repetitions

n —number of repetitions for whole calibration curve

\bar{x} — x mean value

$$Q_{xx} = \sum (x - \bar{x})^2 \quad (3)$$

Concentration of other determined analytes (determined separately and as TVOCs) was calculated as toluene equivalents. Toluene (CHROMASOLV Plus, for HPLC, 99.9% purity, Honeywell) calibration solutions were prepared in the same way like limonene standard solutions. The five-point calibration curve was created using the following concentrations of toluene standard solutions: 2.0; 4.0; 6.0; 8.0; and $10.0 \text{ ng}/\mu\text{L}$. All of the calculations were performed similarly

as in the case of limonene calibration. Therefore, the following values of metrological parameters were obtained: LOD = 1.9 ng, LOQ = 5.8 ng; for 2-l air samples MLOD = 0.95 $\mu\text{g m}^{-3}$ (0.25 ppbv), MLOQ = 2.9 $\mu\text{g m}^{-3}$ (0.77 ppbv). Percentage standard uncertainty was equal to 8.1%.

Results and discussion

In 1992, ECA (European Collaborative Action) released Report 11 “Guidelines for Ventilation Requirements in Buildings,” according to which there are 4 comfort ranges of TVOCs indoors, proposing 300 $\mu\text{g m}^{-3}$ as target guideline concentration for TVOCs indoors (European Collaborative Action 1992):

- < 200 $\mu\text{g m}^{-3}$ —comfort range
- 200–3000 $\mu\text{g m}^{-3}$ —multifactorial exposure range
- 3000–25,000 $\mu\text{g m}^{-3}$ —discomfort range
- > 25,000 $\mu\text{g m}^{-3}$ —toxic range

Unfortunately, only few countries have guidelines for indoor TVOC concentrations: Germany 300 $\mu\text{g m}^{-3}$ (Seifert 1990), the USA 200 $\mu\text{g m}^{-3}$ (USA-EPA 1996), Australia

500 $\mu\text{g m}^{-3}$ (NHMRC 1993), Finland 200–600 $\mu\text{g m}^{-3}$ (FISIAQ et al. 1955). In Poland, there is no regulation for TVOC concentrations; there are several but only for some specific VOCs. However, taking into consideration the values from other countries, one may state that TVOC concentration of 300–400 $\mu\text{g m}^{-3}$ indicates that indoor air quality requires deeper investigation. Moreover, in Report 19, released by the ECA in 1997, it is mentioned that TVOC concentration above 25 mg m^{-3} increases the likelihood of sensory effects such as: dryness, sensory irritation, weak inflammatory irritation of eyes, nose, airways, and skin (ECA 1997).

The first step of this research was to determine, as recommended by the ECA (ECA 1997), as many volatile compounds as possible in collected air samples, at least those which are the most abundant. Qualitative analysis was done by TD-GC-MS. MS NIST 2.0 library was used to identify detected VOCs. On this basis, the list of most commonly occurring VOCs was created, which concerned compounds that were identified by NIST 2.0 library with probability higher than 70% (see Appendix Table 6).

TVOC concentration variations determined during all sampling days in all investigated spa salons are depicted in Fig. 2.

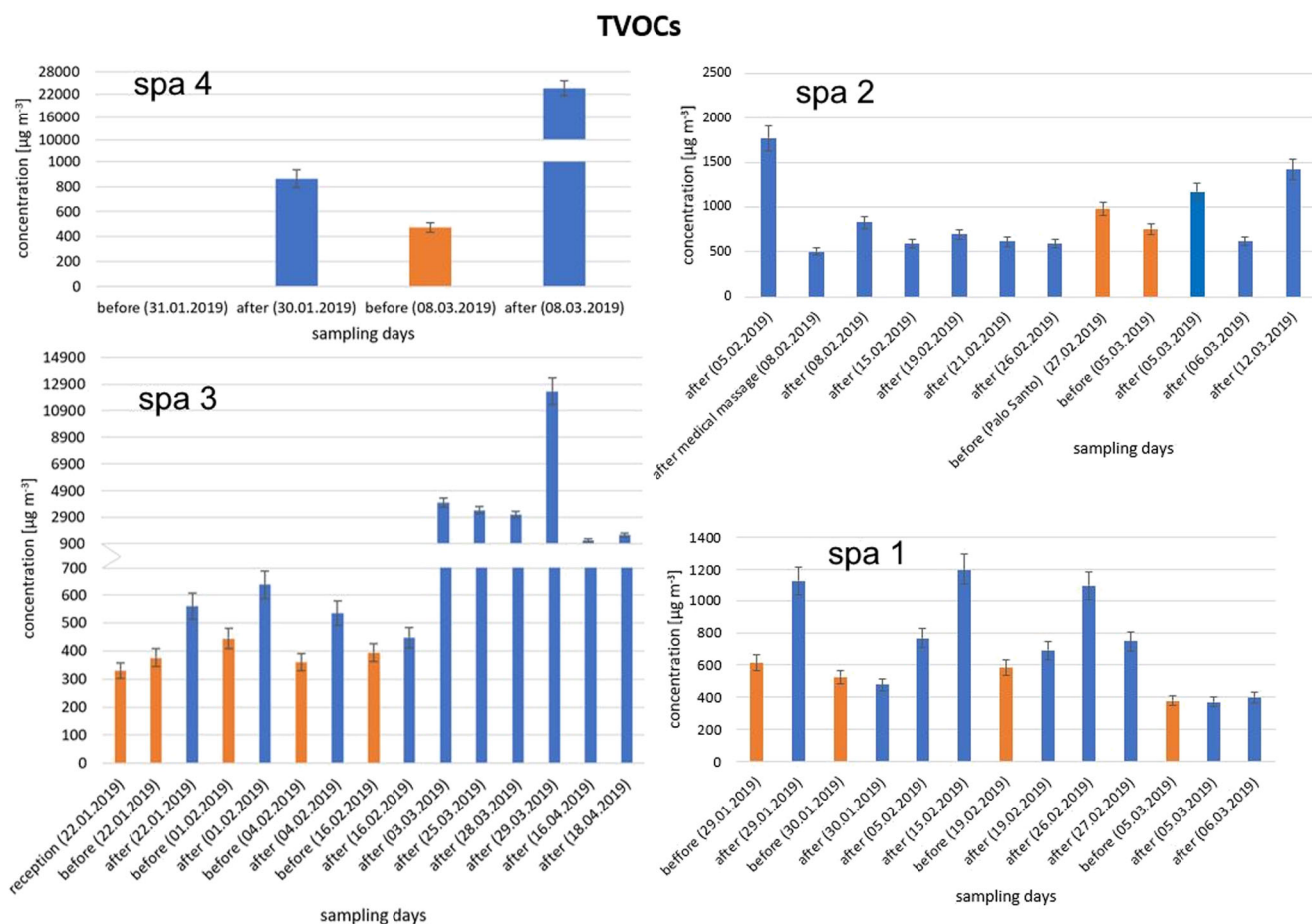

Fig. 2 Variations in TVOC concentrations determined during sampling campaign in all investigated spa salons

Determined instantaneous concentrations of TVOCs in all spa salons exceeded proposed target concentration of $300 \mu\text{g m}^{-3}$, even before the beginning of the massage. Most commonly, TVOC concentrations determined before treatment were lower than concentrations determined after the treatment, with two exceptions in spa 1 on the following sampling days: 30 January 2019 and 05 March 2019. High concentration of TVOCs measured before the beginning of treatments was probably related to high TVOC concentration in indoor air on the previous day. Most of the results are within the multifactorial exposure range. One exception is TVOC concentration measured in spa 4 after the massage— $23,694 \mu\text{g m}^{-3}$, which was almost in the toxic range. However, because measured concentrations were instantaneous, it cannot be clearly stated whether they pose a serious threat to human health, as the effect depends on how long the exposition to high concentrations lasts. This particular spa salon (spa 4) is not specialized in very scented and relaxing massages. Usually, physiotherapeutic massages are carried out there. Moreover, the number of carried out treatments per day is not so high like in case of, e.g., spa 1, in which all three massage rooms are simultaneously occupied for most of the time.

Interesting fact is that in case of spa 2, concentration of TVOCs on 27 February 2019 was higher than on most of the other days when sampling was carried out after treatment. This was probably due to the smoldering of Palo Santo branch that day. According to the literature, Palo Santo (*Bursera graveolens*) essential oil is mostly composed of terpenes. Sotelo Mendez and co-workers (Sotelo Mendez et al. 2017) investigated the chemical composition of Palo Santo essential oil from Peru and determined that α -terpinene is a dominating component. It has been proved that the country of origin plays an important role in Palo Santo essential oil composition, since Fon-Fay et al. (2019) indicated that limonene constitutes 34.9% of the composition of *Bursera graveolens* essential oil from Ecuador, whereas according to the results obtained for essential oil from Peru (Sotelo Mendez et al. 2017), limonene constituted only 0.19% of its composition. In spa 2 on 27 February 2019, Palo Santo began to smolder approximately an hour before the official opening of the salon and more than one branch was used that day; therefore, it is highly probable that this activity was responsible for such high TVOC concentration measured, despite the fact that sampling was done before any massage started.

Generally observable trend was that TVOC concentration increased after each treatment in all spa salons. The greatest impact of the carried out treatment on the indoor air chemical composition was observable in the case of spa 4 on 08 March 2019. The TVOC concentration in sample collected after the massage was 55 times higher than that in the one collected before it started. During this treatment, a mixture of the following essential oils was applied: orange, lilac petals, Scots pine, and synthetic orange fragrance; whereas on the

chimneys, there was lemongrass oil with wild rose and orange oils, which made this massage exceptionally aromatic. Taking into consideration the sharp increase of TVOC concentration after the massages with the application of essential oils, it may be stated that increased temperature inside the massage room, warm human skin and its large area contribute to intensified exposure of both workers and clients of spa salons to increased concentration of TVOCs, including terpenes (especially those of high volatility), in indoor air. This has been also proved by the results obtained by Huang et al. (2012) and Hsu et al. (2012) within their investigations on aromatherapy environments. In that studies, TVOC concentrations before massages was in the range $400\text{--}600 \mu\text{g m}^{-3}$ and $250\text{--}500 \mu\text{g m}^{-3}$ correspondingly, which is consistent with measurement in this research's "initial" concentrations in the range $450\text{--}600 \mu\text{g m}^{-3}$. Huang et al. (2012) determined the highest TVOC concentration in 125–175 min of the measurement (during first aromatherapy session), and it reached $1200 \mu\text{g m}^{-3}$, while in Hsu et al. (2012) research, the highest noted TVOC concentration was equal to $3250 \mu\text{g m}^{-3}$ (for the details, see References). Determined in our study, TVOC concentration range of $600\text{--}1200 \mu\text{g m}^{-3}$ (with the exception of measured in spa 4 exceptionally high value of TVOC concentration) is close to the discussed above cases.

To get closer to the main purpose of this research, a percentage share of terpene concentration in relation to all determined TVOCs was calculated and presented in Fig. 3.

Applied during the treatment in spa 1, coconut and tea tree oils did not contribute significantly to percentage share of terpene concentration in relation to determined TVOCs. Relatively low (22%) content of terpenes in collected air sample was caused by the fact that coconut oil is not an essential oil and it is mainly composed of fatty acids (Marina et al. 2009); hence, the only source of terpenes in this case was tea tree oil heated on the chimney. In spa 2, a massage with an application of geranium and orchid oils resulted in elevated terpene percentage share in comparison to spa 1, which can be explained by the application of two essential oils during treatment. After the massage in spa 3, during which sesame and orange oils were applied, percentage content of terpenes in collected sample was equal to 60%, probably due to the fact that orange oil is mainly composed of limonene (77–95%) (Verzera et al. 2004; Tao et al. 2009). Application of large amounts of different essential oils during treatment in spa 4 (orange, lilac petals, Scots pine, lemongrass, wild rose) resulted in very large percentage share of terpenes in air sample composition equal to 86%. These results indicate that terpene content in spa indoor air depends on the type (chemical composition) and amount of applied oils and cosmetics during aromatherapy.

According to the ECA, it is possible that specific VOCs may influence indoor air quality and may be solely responsible for or partially contribute to the development of health

Fig. 3 Percentage share of sum of terpenes and other VOCs in relation to TVOC content in air samples collected in investigated spa salons on exemplary sampling days

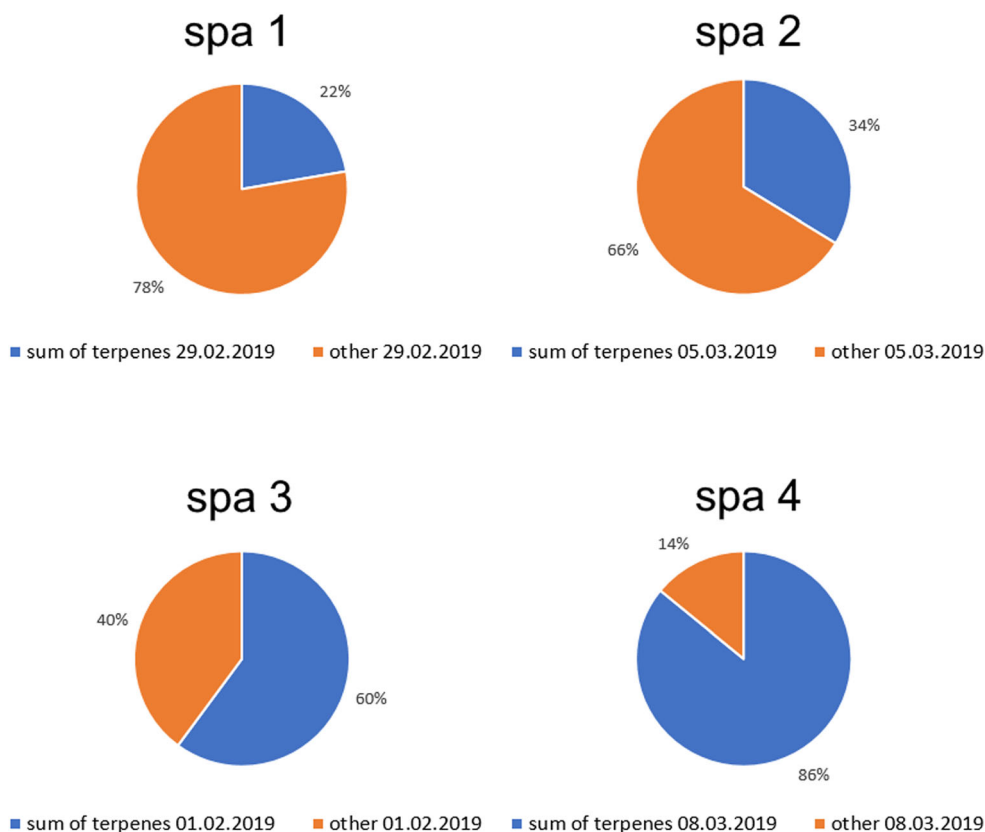

effects in greater extent than other VOCs. If such circumstances are suspected to occur, these specific VOCs (or one specific VOC) should be listed and determined separately (ECA 1997). Therefore, full list of 21 quantitatively determined chemical compounds is available in Appendix Tables 2, 3, 4, and 5, whereas four terpene compounds that were determined at highest concentration levels (α -pinene, limonene, camphene, and linalool) are discussed in detail below. According to the literature, these compounds are commonly investigated in terms of indoor air quality because of high abundance of their emission sources indoors. α -Pinene and limonene are the most commonly occurring terpenes in indoor environments. Camphene is also frequently determined terpene, but it is present in indoor air at concentrations lower than limonene and α -pinene (Tanaka-Kagawa et al. 2005; de Gennaro et al. 2013). Linalool is not so frequently determined in indoor air quality research as aforementioned terpenes, but it was proved that the application of essential oils is responsible for high emission of this compound (Su et al. 2007). Concentration variations of these selected compounds, determined by TD-GC-FID before and after massage treatment, are presented in Fig. 4. To date, terpene emission sources were the same as discussed above.

According to the results presented in Fig. 4, limonene was the most abundant monoterpene in all investigated spa salons and its background concentration (before treatment) varied

from 25 to 60 $\mu\text{g m}^{-3}$, which is similar to limonene concentration measured in studies on indoor air quality of shopping malls (Amodio et al. 2014) or homes (Villanueva et al. 2015). Concentrations of α -pinene, camphene, and linalool before treatments did not exceed 100 $\mu\text{g m}^{-3}$. Concentrations of monoterpenes after massage treatment are visibly higher than before treatment, which indicates the presence of strong emission sources. Extremely high increase of limonene concentration up to 18,947 $\mu\text{g m}^{-3}$ was probably caused by the use of complex essential oil mixture applied in huge amounts, which resulted also in increased TVOC concentration. Hsu et al. (2012) indicated in their research that limonene has very similar increasing concentration trend as TVOCs and its concentration in samples collected after massage was 16 to 60 times higher than in those collected before the treatment started. In our study, this range was even greater, since limonene concentration in indoor air after massage was from 2.5 to almost 740 times greater than before.

Since limonene is one of the most commonly occurring monoterpenes in indoor air and, as it was already mentioned, it was the most abundant monoterpene in all studied salons, we investigated particularly limonene concentration variations along all sampling days. Results of this investigation are presented in Table 1 as percentage share of limonene concentration in the sum of terpene concentrations. Such divergent results prove that each salon is a

Fig. 4 Variations of four representative terpenes determined before and after massage treatments in all investigated spa salons

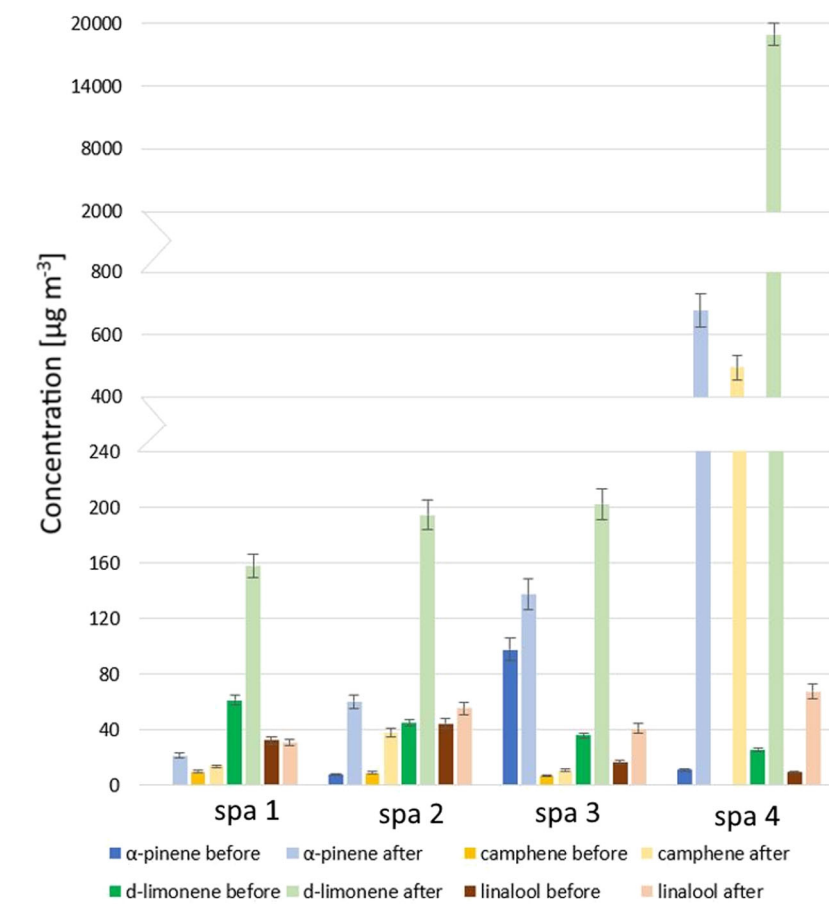

specific and characteristic environment with dynamically changing indoor air chemistry. All activities and applied cosmetic products have an influence on indoor environment of each of the salons; therefore, chemistry of spa salons cannot be unified and has to be specified for each of the salon separately.

In order to better describe the air quality of investigated salons, obtained qualitative results were combined to create charts showing percentage content of specific groups of chemical compounds in collected air samples. These results are presented in Fig. 5.

On the basis of collected data presented in Fig. 5, it may be stated that the type of the oil applied during the session highly influences the chemical composition of air inside the room where it took place. The presence of compounds of other than monoterpene groups of chemicals is probably related to the fact that commercially available essential oils (applied during investigated aromatherapy sessions) are rarely composed of 100% pure essential oil. It is very common that they contain additives such as alcohols, some other terpenes, and/or other fragrance compounds. However, the use of monoterpene-rich essential oils or cosmetic products with such essential oils, e.g., fir needle oil mainly composed of β -pinene (35–48%)

(Régimbal and Collin 1994), orange oil mainly composed of limonene (77–95%) (Verzera et al. 2004; Tao et al. 2009), geranium oil rich in citronellol (37.5%) (Sharopov et al. 2014), or sage oil rich in 8-cineole (71.6%) (Borek et al. 2006), results in the dominant percentage share of terpenes in the investigated air samples. Geranium oil additionally contains a large fraction of alcohols in its composition (50–60%) (Babu and Kaul 2005), which also significantly influences collected air sample composition (see Fig. 5, spa 2 sampling day 07 March 2019). “Indian flower” is a commercial name of mixture of essential oils, which is unfortunately unavailable to check; therefore, it is impossible to speculate on its composition.

The high impact of the type (and composition) of essential oil during the treatment on the percentage content of limonene among all chemical compounds determined in air samples may be indicated with the example of spa 3 indoor air sample composition. Amounts of alcohols, organic acids, esters, ethers, aldehydes, alkenes, alkanes, siloxanes, ketones, and other compounds are very alike between two sampling days. A significant difference concerns limonene content. Rose oil applied on 26 March 2019 does not contain limonene; however, it contains significant amounts of other terpenes and

Table 1 Concentration of limonene expressed as absolute value and percentage share in relation to a sum of terpene concentration measured within the research

	Before treatment				After treatment			
	Min	Max	Arithmetic mean	Geometric mean	Min	Max	Arithmetic mean	Geometric mean
Spa 1	37.9 ± 2.1 (46.8)	146.1 ± 8.0 (71.1)	92.0 ± 5.1 (57.1)	74.4 ± 4.1 (56.2)	72.6 ± 4.0 (50.6)	108.5 ± 6.0 (73.9)	90.6 ± 5.0 (59.8)	88.7 ± 4.9 (59.3)
Spa 2	44.8 ± 2.5 (38.9)	141.4 ± 7.8 (52.8)	93.1 ± 5.1 (45.8)	79.6 ± 4.4 (45.3)	62.4 ± 3.4 (4.3)	105.5 ± 5.8 (59.5)	84.0 ± 4.7 (36)	81.2 ± 4.5 (29.4)
Spa 3	25.5 ± 1.4 (14.8)	35.9 ± 2.0 (20.9)	30.7 ± 1.7 (17.4)	30.2 ± 1.7 (17.3)	8.4 ± 0.5 (0.3)	1032.4 ± 56.8 (78)	520.4 ± 28.6 (47.5)	93.1 ± 5.1 (29.7)
Spa 4	< LOD (-)	25.6 ± 1.4 (38.8)	-	-	289.5 ± 15.9 (60.1)	18,950.8 ± 1042.3 (93.1)	9620.2 ± 529.1 (76.6)	2342.5 ± 128.8 (74.8)

scented terpene derivatives (geraniol 22%, nerol 10%, and citronellol 35%) (Ulusoy et al. 2009). Mixture of essential oils (ylang ylang, lavender, pink grapefruit oils) applied on 25 March 2019 changed limonene percentage share in sample chemical composition significantly. Ylang ylang and lavender oils contain trace amounts of limonene (Stashenko et al. 1996; Baratta et al. 1998; Hui et al. 2010); however, this terpene is a main component of pink grapefruit oil (88–91%) (Njoroge et al. 2005; Uysal et al. 2011); therefore, limonene was an abundant component of air sample collected that day.

Huang et al. (2012) and Hsu et al. (2012) in their studies determined that aromatherapy treatment causes submicron (< 100 nm) SOA particles growth at a level from 10,000 to 100,000 particles/cm³, indicating that high terpene concentration in such environments, even at low-level ozone concentration, produces large amounts of nanosized SOA. Additionally, terpene oxidation reactions in terpene-rich environments caused formation of formaldehyde up to 0.025 ppm, while background concentration was equal up to 0.005 ppm and I/O (indoor to outdoor ratio) indicated that formaldehyde emission sources were mainly indoors. Taking above into consideration together with obtained results within this study, it may be stated that indoor air quality in spa salons may pose a risk to human health and well-being.

Summary and conclusions

This study, aimed at investigation of indoor air quality with particular emphasis on terpene presence in specific kind of environments such as spa salons, is, to the best of our knowledge, the first research of this type carried out in Poland. Results obtained within this study allowed to characterize indoor air quality and composition in selected spa salons. It has been proved that spa salons are characterized by TVOC concentrations exceeding recommended values of 300–400 µg m⁻³ and that TVOC concentration is strictly related to salon characteristics and carried out treatments. The evaluation of data gathered during this study indicates that terpenes constitute a significant part of TVOCs present in spa indoor air. Elevated terpene concentration is strongly related to the application of essential oils during treatments; however, constant emission sources such as candle chimneys filled with essential oils also contribute to increased terpene (and therefore TVOCs) concentration in indoor air. Indoor air quality in small spaces of spa salons can be easily altered by application of even small amounts of essential oils or cosmetics containing terpenes. It is known now that even small indoor concentration of ozone may trigger the reaction of SOA formation, as long as there is enough of second substrate—terpenes. Employees, by spending 8 h daily in such environment, may be at the risk of high exposure to harmful VOCs and terpene

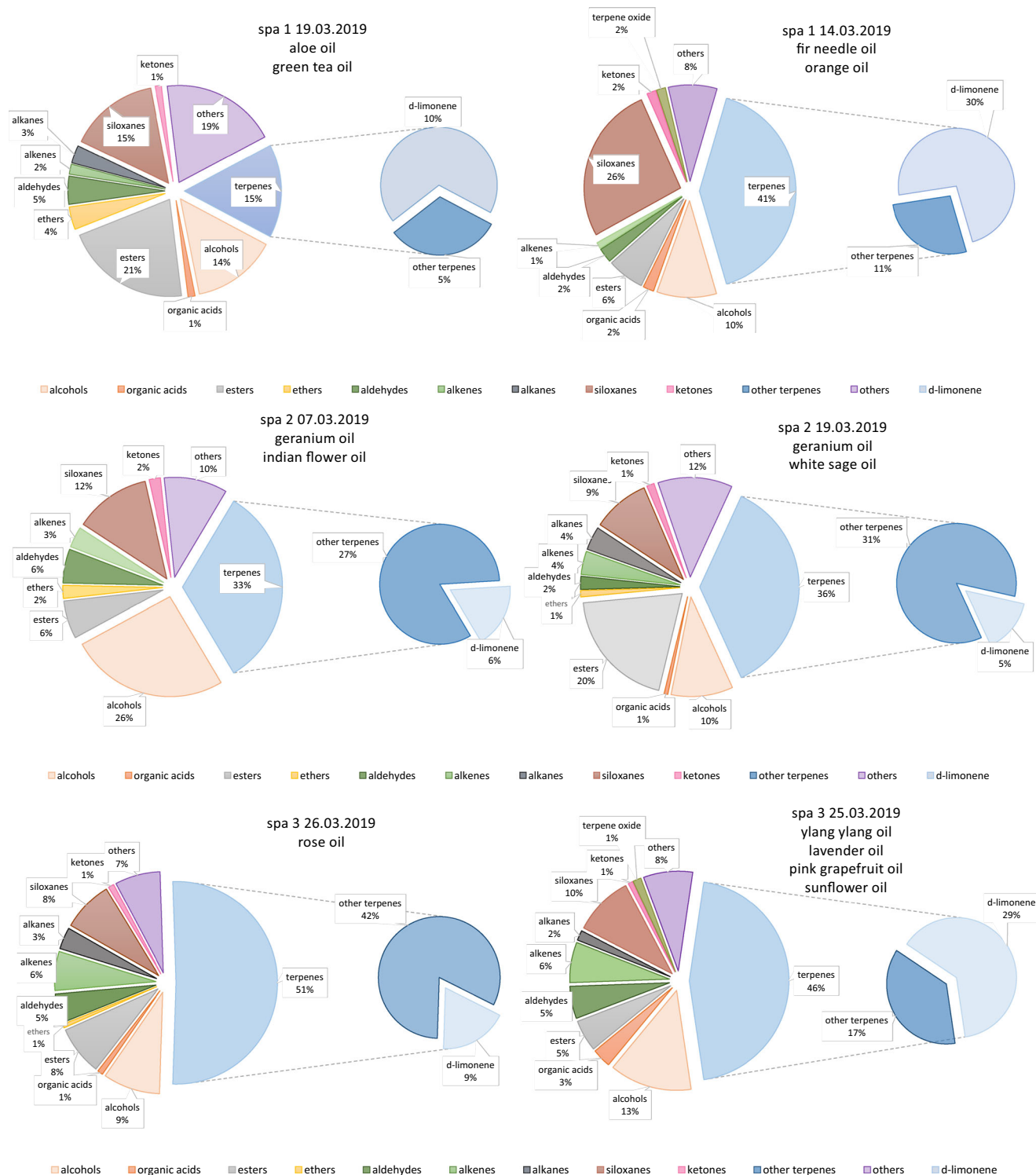

Fig. 5 Percentage share of specific groups of compounds in air samples collected in spa salons with indication of applied essential oils during the treatments

oxidation products, e.g., acetone, formaldehyde, and submicron SOA particles.

Indoor air monitoring in spa salons would be highly advised, as well as checking ventilation/air exchange performance.

Further research in this area supported by toxicological studies would allow for obtaining results required for establishing and introducing of law regulations regarding maximum allowable concentrations of VOCs in these specific indoor environments.

Appendix 1

Table 2 Determined concentrations of selected analytes in samples collected in SPA 1

Determined compounds	SPA 1 date																	
	29.01.2019 Before	29.01.2019 After	30.01.2019 Before	30.01.2019 After	05.02.2019 Before	05.02.2019 After	15.02.2019 Before	15.02.2019 After	19.02.2019 Before	19.02.2019 After	26.02.2019 Before	26.02.2019 After	27.02.2019 Before	27.02.2019 After	05.03.2019 Reception	05.03.2019 After	06.03.2019 After	
	Concentration (ppbv)																	
Isopropyl alcohol	20.64	n.d.	n.d.	20.92	n.d.	n.d.	n.d.	n.d.	n.d.	n.d.	n.d.	n.d.	n.d.	n.d.	n.d.	n.d.	n.d.	n.d.
Acetic acid	24.67	n.d.	n.d.	n.d.	n.d.	n.d.	n.d.	n.d.	n.d.	n.d.	n.d.	n.d.	n.d.	n.d.	n.d.	n.d.	n.d.	n.d.
Toluene	n.d.	0.79	< LOQ	0.90	n.d.	0.87	22.49	9.05	< LOQ	< LOQ	4.59	13.85	1.75	3.52	< LOQ	4.11	2.44	< LOQ
Cyclotrisiloxane	15.76	31.39	16.68	18.81	23.42	22.49	32.09	9.05	10.13	10.13	13.85	13.85	3.52	3.52	4.11	4.11	2.44	2.44
2-Propanol	11.13	n.d.	16.30	8.17	23.60	32.09	4.48	n.d.	16.19	16.19	9.23	9.23	16.91	16.91	n.d.	n.d.	n.d.	n.d.
α-Pinene	< LOQ	3.79	1.95	1.05	3.06	4.48	4.48	1.68	3.62	3.62	2.81	2.81	2.55	2.55	2.38	2.38	< LOQ	1.74
Camphene	1.74	2.44	1.37	< LOQ	2.00	2.26	2.26	2.04	3.14	3.14	2.09	2.09	4.29	4.29	0.96	0.96	0.90	1.24
β-Pinene	< LOQ	1.66	1.02	< LOQ	1.25	2.39	2.39	1.05	1.76	1.76	8.09	8.09	< LOD	< LOD	0.90	0.90	0.93	1.13
α-Phellandrene	1.18	1.36	1.11	1.26	1.72	2.68	2.68	1.07	2.96	2.96	3.15	3.15	6.50	6.50	1.19	1.19	n.d.	2.79
3-Carene	< LOQ	< LOQ	< LOQ	1.26	< LOQ	< LOQ	< LOQ	< LOQ	< LOQ	< LOQ	< LOD	< LOD	< LOQ	< LOQ	n.d.	n.d.	1.60	< LOQ
D-Limonene	11.02	28.37	7.11	3.91	11.89	13.06	13.06	26.28	34.75	34.75	30.16	30.16	< LOD	< LOD	6.81	6.81	5.79	19.51
β-Phellandrene	n.d.	< LOQ	< LOQ	n.d.	< LOQ	0.92	0.92	< LOQ	< LOQ	< LOQ	2.18	2.18	< LOQ	< LOQ	< LOQ	< LOQ	1.79	< LOQ
Eucalyptol	0.85	1.82	1.02	< LOQ	1.64	1.34	1.34	2.98	7.82	7.82	6.06	6.06	n.d.	n.d.	1.42	1.42	< LOQ	2.16
Linalool	5.10	4.88	3.13	0.80	5.16	6.31	6.31	4.65	7.05	7.05	4.58	4.58	7.86	7.86	2.77	2.77	< LOQ	2.39
Undecan	n.d.	n.d.	n.d.	n.d.	3.76	19.34	19.34	4.53	n.d.	n.d.	5.05	5.05	n.d.	n.d.	3.58	3.58	n.d.	3.73
Borneol	n.d.	n.d.	n.d.	n.d.	n.d.	8.13	8.13	n.d.	4.44	4.44	4.19	4.19	n.d.	n.d.	2.28	2.28	n.d.	2.74
Cedrene/eryophyllene	3.52	4.96	2.44	n.d.	n.d.	n.d.	n.d.	4.84	5.99	5.99	4.28	4.28	n.d.	n.d.	2.30	2.30	n.d.	n.d.
Geraniol	< LOQ	n.d.	< LOQ	n.d.	0.97	< LOQ	< LOQ	< LOQ	< LOQ	< LOQ	n.d.	n.d.	n.d.	n.d.	< LOQ	< LOQ	n.d.	n.d.
Citronellal	n.d.	n.d.	n.d.	n.d.	2.46	2.70	2.70	2.31	5.71	5.71	8.08	8.08	1.82	1.82	2.27	2.27	n.d.	4.27
α-Amyl cinnamyl aldehyde	n.d.	n.d.	n.d.	n.d.	n.d.	n.d.	n.d.	n.d.	n.d.	n.d.	n.d.	n.d.	2.99	2.99	n.d.	n.d.	n.d.	n.d.
1,2-Dimethyl-3-nitrobenzene	n.d.	n.d.	n.d.	n.d.	n.d.	n.d.	n.d.	n.d.	< LOQ	< LOQ	n.d.	n.d.	n.d.	n.d.	n.d.	n.d.	< LOQ	n.d.

Appendix 2

Table 3 Determined concentrations of selected analytes in samples collected in SPA 2

Determined compounds	SPA 2 date															
	05.02.2019 After	08.02.2019 After	08.02.2019 After	15.02.2019 After	19.02.2019 After	21.02.2019 After	26.02.2019 After	27.02.2019 Before	05.03.2019 Before	05.03.2019 After	06.03.2019 After	12.03.2019 After				
Concentration (ppbv)																
Isopropyl alcohol	n.d.	29.26	21.26	28.44	7.36	60.90	56.81	n.d.	n.d.	n.d.	n.d.	n.d.	n.d.	n.d.	n.d.	n.d.
Acetic acid	n.d.	n.d.	n.d.	n.d.	n.d.	n.d.	n.d.	n.d.	n.d.	n.d.	n.d.	n.d.	n.d.	n.d.	n.d.	n.d.
Toluene	2.05	0.49	1.05	1.07	1.27	2.18	< LOQ	< LOQ	0.88	0.88	< LOQ	< LOQ	< LOQ	< LOQ	< LOQ	< LOQ
Cycli3siloxane	n.d.	< LOQ	< LOQ	0.80	0.89	0.78	n.d.	7.24	n.d.	0.95	< LOQ	< LOQ	1.56	< LOQ	< LOQ	1.56
2-Propanol	n.d.	n.d.	n.d.	n.d.	n.d.	3.69	n.d.	n.d.	n.d.	n.d.	n.d.	n.d.	n.d.	n.d.	n.d.	n.d.
α-Pinene	1.34	2.42	5.13	4.57	6.35	4.21	3.41	3.00	5.66	10.82	12.32	5.10	12.32	12.32	5.10	5.10
Camphene	1.34	1.62	3.18	1.69	2.48	0.87	2.17	2.52	1.59	6.87	2.48	3.48	2.48	2.48	3.48	3.48
β-Pinene	1.27	< LOQ	1.65	1.44	1.40	3.00	1.75	2.87	1.35	3.52	6.47	4.92	6.47	6.47	4.92	4.92
α-Phellandrene	0.80	0.99	1.59	1.25	0.96	2.75	< LOQ	3.34	1.35	1.28	2.17	< LOQ	2.17	2.17	< LOQ	< LOQ
3-Carene	6.26	1.70	1.97	1.96	2.09	3.84	< LOQ	1.67	2.72	2.58	3.50	7.01	3.50	3.50	7.01	7.01
D-Limonene	11.23	18.97	20.48	10.16	9.03	4.32	9.19	25.43	8.06	35.02	14.54	14.82	14.54	14.54	14.82	14.82
β-Phellandrene	237.98	6.21	3.92	5.47	2.74	7.21	n.d.	6.45	n.d.	10.74	31.88	9.63	31.88	31.88	9.63	9.63
Eucalyptol	1.07	2.42	7.55	2.10	5.16	< LOQ	2.16	3.44	5.21	5.40	4.53	12.92	4.53	4.53	12.92	12.92
Linalool	1.65	5.38	14.51	8.88	12.63	1.16	7.80	8.58	7.04	8.79	8.85	9.61	8.85	8.85	9.61	9.61
Undecan	n.d.	3.38	n.d.	7.35	4.47	2.41	3.73	6.82	9.52	8.37	n.d.	10.66	n.d.	n.d.	10.66	10.66
Borneol	n.d.	1.51	4.49	1.59	3.66	n.d.	1.55	4.21	n.d.	n.d.	n.d.	n.d.	n.d.	n.d.	n.d.	n.d.
Cedrene/cryophyllene	n.d.	n.d.	2.04	1.04	1.75	n.d.	< LOQ	2.89	n.d.	n.d.	n.d.	n.d.	n.d.	n.d.	n.d.	n.d.
Lilial	n.d.	n.d.	n.d.	n.d.	3.60	n.d.	n.d.	n.d.	n.d.	n.d.	n.d.	n.d.	n.d.	n.d.	n.d.	n.d.
Geraniol	n.d.	1.03	3.29	0.97	1.11	n.d.	< LOQ	< LOQ	1.49	1.49	< LOQ	n.d.	< LOQ	< LOQ	n.d.	n.d.
1,2-Dimethyl-3-nitrobenzene	< LOQ	n.d.	n.d.	n.d.	n.d.	< LOQ	n.d.	n.d.	n.d.	n.d.	n.d.	n.d.	n.d.	n.d.	n.d.	n.d.
Citronellal	n.d.	n.d.	3.87	1.74	3.22	n.d.	n.d.	6.77	n.d.	n.d.	n.d.	n.d.	n.d.	n.d.	n.d.	n.d.

Appendix 3

Table 4 Determined concentrations of selected analytes in samples collected in SPA 3

Determined compounds	SPA 3 date							
	22.01.2019 Reception	22.01.2019 Before	22.01.2019 After	01.02.2019 Before	01.02.2019 After	04.02.2019 Before	04.02.2019 After	16.02.2019 Before
	Concentration (ppbv)							
Isopropyl alcohol	2.56	31.43	8.00	21.47	23.94	35.15	28.93	21.61
Toluene	1.44	2.21	2.23	2.28	2.62	1.72	2.12	2.87
α-Pinene	13.19	20.34	18.90	17.55	24.70	17.97	23.51	12.40
Camphene	1.34	1.12	1.79	1.17	1.89	1.18	1.56	0.95
β-Pinene	< LOQ	< LOQ	0.78	0.84	0.93	1.07	1.39	2.97
α-Phellandrene	< LOQ	< LOQ	2.02	< LOQ	< LOQ	< LOQ	1.98	0.83
3-Carene	4.44	4.90	4.82	4.90	5.03	5.38	5.74	6.54
D-Limonene	4.02	4.59	25.23	6.45	36.43	5.80	14.48	4.40
β-Phellandrene	< LOQ	< LOQ	n.d.	n.d.	n.d.	n.d.	n.d.	< LOQ
Eucalyptol	< LOQ	< LOQ	0.94	< LOQ	< LOQ	< LOQ	< LOQ	< LOQ
Linalool	2.43	1.79	0.93	2.60	6.49	1.63	5.70	1.14
Undecan	n.d.	n.d.	n.d.	n.d.	n.d.	n.d.	2.28	2.01
4-Methoxy benzyl alcohol	1.77	< LOQ	< LOQ	2.84	n.d.	< LOQ	n.d.	n.d.
Geraniol	n.d.	n.d.	n.d.	n.d.	n.d.	n.d.	n.d.	< LOQ
Cireonellal	n.d.	n.d.	n.d.	n.d.	n.d.	n.d.	n.d.	< LOQ

Determined compounds	SPA 3 date							
	16.02.2019 After	03.03.2019 After	25.03.2019 After	28.03.2019 After	29.03.2019 After	16.04.2019 After	18.04.2019 After	
	Concentration (ppbv)							
Isopropyl alcohol	n.d.	n.d.	n.d.	n.d.	n.d.	n.d.	n.d.	
Toluene	1.82	n.d.	n.d.	5.67	n.d.	n.d.	5.15	
α-Pinene	0.96	24.34	87.96	74.65	120.36	26.56	29.87	
Camphene	< LOQ	7.20	15.51	10.52	46.55	9.86	5.85	
β-Pinene	< LOQ	24.30	5.20	5.07	299.46	3.02	2.18	
α-Phellandrene	0.82	n.d.	6.99	3.54	n.d.	4.12	1.46	
3-Carene	3.88	389.20	20.11	16.97	114.74	8.73	6.97	
D-Limonene	4.81	1.51	327.11	288.41	305.04	185.69	91.99	
β-Phellandrene	8.34	n.d.	n.d.	n.d.	71.55	n.d.	n.d.	
Eucalyptol	n.d.	< LOQ	6.18	n.d.	n.d.	< LOQ	1.43	
Linalool	93.00	2.98	30.69	4.97	117.50	23.85	19.10	
Undecan	n.d.	n.d.	n.d.	n.d.	n.d.	n.d.	13.27	
4-Methoxy benzyl alcohol	n.d.	n.d.	n.d.	n.d.	n.d.	n.d.	n.d.	
Geraniol	n.d.	n.d.	n.d.	24.74	n.d.	n.d.	n.d.	
Cireonellal	n.d.	n.d.	1.2	n.d.	1.61	< LOD	< LOD	

Appendix 4

Table 5 Determined concentrations of selected analytes in samples collected in SPA 4

Determined compounds	SPA 4 date			
	30.01.2019 Before Concentration (ppbv)	30.01.2019 After	06.02.2019 Before	08.03.2019 After
Isopropyl alcohol	n.d.	n.d.	n.d.	3.25
Acetic acid	n.d.	n.d.	n.d.	n.d.
Toluene	n.d.	< LOD	0.82	n.d.
Cycli3siloxane	n.d.	n.d.	n.d.	1.25
2-Propanol	n.d.	n.d.	n.d.	n.d.
α -Pinene	n.d.	26.14	1.96	121.95
Camphene	n.d.	2.71	< LOQ	89.17
β -Pinene	n.d.	3.57	< LOQ	16.40
α -Phellandrene	n.d.	< LOQ	< LOQ	4.32
3-Carene	n.d.	2.16	< LOQ	17.84
D-Limonene	n.d.	52.08	4.61	3408.67
β -Phellandrene	n.d.	n.d.	n.d.	n.d.
Eucalyptol	n.d.	1.37	< LOQ	5.57
Linalool	n.d.	3.72	1.49	10.73
Undecan	n.d.	20.11	3.31	n.d.
Borneol	n.d.	n.d.	n.d.	2.12
Cedrene/cryophyllene	n.d.	n.d.	5.30	2.36
Lilial	n.d.	n.d.	n.d.	n.d.
Geraniol	n.d.	n.d.	< LOQ	2.68
α -Amyl cinnamyl aldehyde	n.d.	n.d.	< LOQ	n.d.

Appendix 5

Table 6 VOCs identified by MS NIST 2.0 library with probability higher than 70%

SPA 1	SPA 2	SPA 3	SPA 4
Isopropyl alcohol	Isopropyl alcohol	Isopropyl alcohol	2-Methyl-1,3-butadiene
Acetic acid	1-Propanol	Acetic acid	Acetic acid
Ethyl acetate	1-Methoxy-2-propanol	Ethyl acetate	2-Butanone
Pentanal	Hexamethyl-cyclotrisiloxane	1-Butanol	Ethyl acetate
2-Heptanol	Hexanal	Pentanal	Toluene
Propylene glycol	4,5-Diethyl-octane	1,2-Dichloropropane	Hexamethyl-cyclotrisiloxane
Toluene	2-Methyl-octane	Propylene glycol	α -Thujene
Hexamethyl-cyclotrisiloxane	3-Methyl-octane	1-Pentanol	α -Pinene
Hexanal	Ethylbenzene	Toluene	Camphene
Butyl ester acetic acid	p-Xylene	Hexamethyl-cyclotrisiloxane	Cosmone
Ethyl ester 2-methyl butanoic acid	Nonane	Hexanal	β -Phellandrene
p-Xylene	trans-1-Ethyl-4-methyl-cyclohexane	Butyl ester acetic acid	β -Pinene
Heptanal	2,4,6-Trimethyl-heptane	Ethylbenzene	3-Carene
1-Butoxy-2-propanol	3,5-Dimethyl-octane	p-Xylene	Limonene
α -Pinene	1-Ethyl-2-methyl-cyclohexane	Heptanal	Terpinene
Benzaldehyde	2,6-Dimethyl-octane	Propanol	o-Isopropenyltoluene
β -Pinene	3-Ethyl-2-methyl-heptane	α -Pinene	Decamethyl-cyclopentasiloxane
Hexyl ester acetic acid	Butyl-cyclopentane	Butyl-cyclohexane	1-Methyl-4-(1-methylethyl)benzene
1,1'-oxybis-2-Propanol	Propyl-cyclohexane	α -Pinene	ocimene
1-Methyl-4-(1-methylethyl)benzene	4-Methyl-nonane	4-Methyl-nonane	(E,Z)-2,6-Dimethyl-2,4,6-octatriene
Limonene	3-Ethyl-octane	3-Ethyl-octane	Limonaketone
Benzyl alcohol	1-Ethyl-3-methyl-benzene	1-Ethyl-3-methyl-benzene	Naphthalene
Eucalyptol	1-Ethyl-2-methyl-benzene	1-Ethyl-2-methyl-benzene	1,7,7-Trimethyl-bicyclo[2,2,1]hept-2-yl acetic acid ester
(E)-2-Octenal	1,2,3-Trimethyl-benzene	1-Ethyl-2-methyl-benzene	
2,6-Dimethyl-7-octen-2-ol	decane	1,2,3-Trimethyl-benzene	
Acetophenone	cis-1,4-Dimethyl-cyclohexane	decane	
Undecane	4-Methyl-decane	1-Methyl-decane	
Decamethyl-cyclopentasiloxane	1-Methyl-4-(1-methylethyl)-benzene	1-Methyl-4-(1-methylethyl)-benzene	
3,7-Dimethyl-1,6-octadien-3-ol	Limonene	Limonene	
Phenylethyl alcohol	Eucalyptol	Eucalyptol	
Phenylmethyl ester acetic acid	2-Methyl-decane	2-Methyl-decane	
1,7,7-Trimethylbicyclo[2,2,1]heptan-2-one	1-Methyl-3-propyl-benzene	1-Methyl-3-propyl-benzene	
Dodecane	1-Ethyl-2,3-dimethyl-benzene	1-Ethyl-2,3-dimethyl-benzene	
Cardenol	Undecane	Undecane	
4-Carene	Decamethyl-cyclopentasiloxane	Decamethyl-cyclopentasiloxane	
Naphthalene	3,7-Dimethyl-1,6-octadien-3-ol	3,7-Dimethyl-1,6-octadien-3-ol	
2-Phenoxy-ethanol	3,7-Dimethyl-decane	3,7-Dimethyl-decane	
Dodecamethyl-cyclohexasiloxane	Phenylethyl alcohol	Phenylethyl alcohol	
(S)-2-Methyl-5-(1-methylethyl)-2-cyclohexen-1-one	2-Methyl-undecane	2-Methyl-undecane	
2-(1,1-Dimethylethyl)-cyclohexanol	Tritetracontane	Tritetracontane	
Isobornyl acetate	1-Methyl-2-(1-methylethyl)-benzene	1-Methyl-2-(1-methylethyl)-benzene	
2,2,4,4,6,8,8,-heptamethyl-nonane	5-Methyl-2-(1-methylethyl)-cyclohexanone	5-Methyl-2-(1-methylethyl)-cyclohexanone	
tetradecane			

Table 6 (continued)

SPA 1	SPA 2	SPA 3	SPA 4
Nopyl acetate	1,7,7-Trimethylbicyclo[2.2.1]heptan-2-one	Cyclohexanol	
4-(2,6,6-Trimethyl-2-cyclohexen-1-yl)-3-penten-2-one	p-Allyl-Anisole	p-Meth-1-en-8-ol	
4-(2,6,6-Trimethyl-2-cyclohexen-1-yl)-3-buten-2-one	p-Menth-1-en-8-ol	(Z)-3,7-Dimethyl-1,3,6-octatriene	
Lilial	(R)-3,7-Dimethyl-6-octen-1-ol	Dodecamethyl-cyclohexasiloxane	
Penyl ester 2-hydroxy benzoic acid	(Z)-3,7-Dimethyl-2,6-octadienal	(E)-2-Decanal	
Diethyl phthalate	Dodecamethyl-cyclohexasiloxane	(S)-2-Methyl-5-(1-methylethyl)-2-cyclohexen-1-one	
1,1'-Oxybis-octane	3-Methyl-6-(1-methylethyl)-2-cyclohexen-1-one	Tridecane	
Methyl ester 3-oxo-2-pentylmethylcyclopentaneacetic acid	Tridecane	2-(1,2-Dimethyl-1-ethoxy)-cyclohexanol	
Penyl ester 2-hydroxy benzoic acid	(1S-endo)-1,7,7-Trimethylbicyclo[2.2.1]heptan-2-ol	Isobomyl acetate	
Isopropyl myristate	2-(1,1-Dimethyl-1-ethoxy)-cyclohexanol	2,2,4,4,6,8,8-Heptamethyl-nonane	
1-Pentanol	Isobomyl acetate	tetradecamethyl-cycloheptasiloxane	
o-Xylene	4-tert-Butylcyclohexyl acetate	α -Cedrene	
Camphene	3-Methyl-6-(1-methylidene)-cyclohexene	Cedr-9-ene	
Hexanoic acid	Butyl ester butanoic acid	Nopyl acetate	
3-Carene	Copaene	Tricycloaryophylene	
(E,Z)-2,6-Dimethyl-2,4,6-octatriene	4-(2,6,6-Trimethyl-2-cyclohexen-1-yl)-3-buten-2-one	Cedrene	
cis-Limonene oxide	Caryophyllene	[4,2,1,1(2,5)]Dec-3-en-9-ol	
trans-Limonene oxide	Pentadecane	Hexadecamethyl-cyclooctasiloxane	
trans-5-methyl-2-(1-methylethyl)-Cyclohexanone	4-(2,6,6-Trimethyl-2-cyclohexen-1-yl)-3-penten-2-one	Hexadecane	
Menthol	4-(2,6,6-Trimethyl-1-cyclohexen-1-yl)-3-buten-2-one	Ethane-1,1-diol dibutanoate	
1-(4-Methylphenyl)-ethanone	Lilial	Cedrol	
Terpineol	Hexadecane	Camphene	
Tetradecamethyl-hexasiloxane	Diethyl phthalate	Decane	
n-Hexyl salicylate	Methyl ester 3-oxo-2-pentyl-cyclopentane acetic acid	1,2,4-Trimethyl-benzene	
	n-Hexyl salicylate	α -Phellandrene	
	Patchouli alcohol	1-Methyl-4-(1-methylethyl)benzene	
	Isopropyl myristate	Benzene	
	Styrene	Undecane	
	Camphene	Linalool	
	β -Pinene	Nonanal	
	4-Carene	(2R-cis)-5-Methyl-2-(1-methylethyl)-cyclohexanone	
	Limonene	p-Allyl-anisole	
	Eucalyptol	Terpineol	
	2,6-Dimethyl-7-octen-2-ol	3,7-Dimethyl-1,6-octadien-1-ol	
	Nonanal	3,7-Dimethyl-2,6-octadienal	
	Camphor	4-tert-Butylcyclohexyl acetate	
	(2R-cis)-5-Methyl-2-(1-methylethyl)-cyclohexanone		
	Borneol		
	Acetic acid		
	2-Butanone		
	Ethyl acetate		
	Benzene		
	Propylene glycol		
	2-Methylpropyl ester acetic acid		
	Toluene		
	3-Methyl-1-butanol acetate		
	2,3-Dimethyl-bicyclo[2.1.1]-hept-2-ene		

Table 6 (continued)

SPA 1	SPA 2	SPA 3	SPA 4
	2-Butoxy ethanol 1-Butoxy-2-propanol Benzaldehyde Octanal α-Phellandrene 3-Carene 2-Methyl-6-methylene-2-octanol Phenylmethyl ester acetic acid 1-(2-Butoxyethoxy)-ethanol p-Methylbenzyl acetate Naphthalene β-Citronellal Citral 1-Methyloctyl ester butanoic acid Pentadecane		

Compliance with ethical standards

Conflict of interest The authors declare that they have no conflict of interest.

Open Access This article is licensed under a Creative Commons Attribution 4.0 International License, which permits use, sharing, adaptation, distribution and reproduction in any medium or format, as long as you give appropriate credit to the original author(s) and the source, provide a link to the Creative Commons licence, and indicate if changes were made. The images or other third party material in this article are included in the article's Creative Commons licence, unless indicated otherwise in a credit line to the material. If material is not included in the article's Creative Commons licence and your intended use is not permitted by statutory regulation or exceeds the permitted use, you will need to obtain permission directly from the copyright holder. To view a copy of this licence, visit <http://creativecommons.org/licenses/by/4.0/>.

References

Abbatt JPD, Chen W (2020) The atmospheric chemistry of indoor environments. *Environ Sci Process Impacts* 22:25–48

Ahn JH, Kim KH, Kim YH, Kim BW (2015) Characterization of hazardous and odorous volatiles emitted from scented candles before lighting and when lit. *J Hazard Mater* 286:242–251. <https://doi.org/10.1016/j.jhazmat.2014.12.040>

Amodio M, Dambruoso PR, de Gennaro G, de Gennaro L, Loiotile AD, Marzocca A, Stasi F, Trizio L, Tutino M (2014) Indoor air quality (IAQ) assessment in a multistorey shopping mall by high-spatial-resolution monitoring of volatile organic compounds (VOC). *Environ Sci Pollut Res* 21:13186–13195. <https://doi.org/10.1007/s11356-014-2544-1>

Anderson SE, Khurshid SS, Meade BJ, Lukomska E, Wells JR (2013) Toxicological analysis of limonene reaction products using an in vitro exposure system. *Toxicol In Vitro* 27:721–730. <https://doi.org/10.1016/j.tiv.2012.11.017>

Arrhenius K, Engelbrektsson J (2016) Development of analytical methods to gain insight into the role of terpenes in biogas plants. *J Anal Bioanal Tech* 7:1–6. <https://doi.org/10.4172/2155-9872.1000324>

Atkinson R, Arey J (2003) Gas-phase tropospheric chemistry of biogenic volatile organic compounds: a review. *Atmos Environ* 37:197–219. <https://doi.org/10.1016/S1352-2310>

Babu KGD, Kaul VK (2005) Variation in essential oil composition of rose-scented geranium (*Pelargonium* sp.) distilled by different distillation techniques. *Flavour Fragr J* 20:222–231. <https://doi.org/10.1002/ffj.1414>

Bakkali F, Averbeck S, Averbeck D, Idaomar M (2008) Biological effects of essential oils—a review. *Food Chem Toxicol* 46:446–475. <https://doi.org/10.1016/j.fct.2007.09.106>

Baratta MT, Dorman HJD, Deans SG, Figueiredo AC, Barroso JG, Ruberto G (1998) Antimicrobial and antioxidant properties of some commercial essential oils. *Flavour Fragr J* 13:235–244

Borek TT, Hochrien JM, Irwin AN (2006) Composition of the essential oil of white sage, *Salvia apiana*. *Flavour Fragr J* 21:571–572. <https://doi.org/10.1002/ffj.1618>

Cheng WH, Lai CH (2014) Sampling gaseous compounds from essential oils evaporation by solid phase microextraction devices. *Atmos Environ* 99:124–129. <https://doi.org/10.1016/j.atmosenv.2014.09.069>

- Chiu HH, Chiang HM, Lo CC, Chen CY, Chiang HL (2009) Constituents of volatile organic compounds of evaporating essential oil. *Atmos Environ* 43:5743–5749. <https://doi.org/10.1016/j.atmosenv.2009.08.002>
- Clausen PA, Wilkins CK, Wolkoff P, Nielsen GD (2001) Chemical and biological evaluation of a reaction mixture of R-(+)-limonene/ozone. *Environ Int* 26:511–522. [https://doi.org/10.1016/S0160-4120\(01\)00035-6](https://doi.org/10.1016/S0160-4120(01)00035-6)
- da Silva Domingos T, Braga EM (2014) Meaning of aromatherapy massage in mental health. *Acta Paul Enferm* 27:579–585
- de Gennaro G, Farella G, Marzocca A, Mazzone A, Tutino M (2013) Indoor and outdoor monitoring of volatile organic compounds in school buildings: indicators based on health risk assessment to single out critical issues. *Int J Environ Res Public Health* 10:6273–6291. <https://doi.org/10.3390/ijerph10126273>
- Dockery DW, Pope AC, Xu X et al (1993) An association between air pollution and mortality in six U.S. cities. *N Engl J Med* 329:1753–1759
- Dudzinska MR, Staszowska A, Polednik B (2012) Ozone, limonene and formaldehyde concentrations in office spaces. In: *Healthy Building*
- Dunning T (2013) Aromatherapy: overview, safety and quality issues. *OA Altern Med* 1:1–6. <https://doi.org/10.13172/2052-7845-1-1-518>
- ECA (1997) Report No 19 Total volatile organic compounds (TVOC) in indoor air quality investigations
- European Collaborative Action (1992) Report No. 11 - Guidelines for ventilation requirements in buildings-European Collaborative Action (ECA). 40
- FISIAQ, RAKI, SAFA, SKOL (1955) Classification of indoor climate, construction and furnishing materials, Helsinki
- Fon-Fay FM, Pino JA, Hernández I, Rodeiro I, Fernández MD (2019) Chemical composition and antioxidant activity of *Bursera graveolens* (Kunth) Triana et planch essential oil from Manabí, Ecuador. *J Essent Oil Res* 31:211–216. <https://doi.org/10.1080/10412905.2018.1564381>
- Gallego E, Roca FJ, Perales JF, Sánchez G, Esplugas P (2012) Characterization and determination of the odorous charge in the indoor air of a waste treatment facility through the evaluation of volatile organic compounds (VOCs) using TD-GC/MS. *Waste Manag* 32:2469–2481. <https://doi.org/10.1016/j.wasman.2012.07.010>
- Grand View Research (2019) <https://www.grandviewresearch.com/industry-analysis/aromatherapy-market>. In: *Aromather. Mark. Size* (Date Accessed 11.01.2020)
- Haghighat F, De Bellis L (1998) Material emission rates: literature review, and the impact of indoor air temperature and relative humidity. *Build Environ* 33:261–277. [https://doi.org/10.1016/S0360-1323\(97\)00060-7](https://doi.org/10.1016/S0360-1323(97)00060-7)
- Hsu D-J, Huang H-L, Sheu S-C (2012) Characteristics of air pollutants and assessment of potential exposure in spa centers during aromatherapy. *Environ Eng Sci* 29:79–85. <https://doi.org/10.1089/ees.2011.0004>
- Huang HL, Sheu SC, Wu YY, Hsu DJ (2011) Comparison of Chinese herbal oils and lemon oil for formation of secondary organic aerosol. *Aerosol Air Qual Res* 11:854–859. <https://doi.org/10.4209/aaqr.2011.07.0093>
- Huang HL, Tsai TJ, Hsu NY, Lee CC, Wu PC, Su HJ (2012) Effects of essential oils on the formation of formaldehyde and secondary organic aerosols in an aromatherapy environment. *Build Environ* 57:120–125. <https://doi.org/10.1016/j.buildenv.2012.04.020>
- Hui L, He L, Huan L et al (2010) Chemical composition of lavender essential oil and its antioxidant activity and inhibition against rhinitis-related bacteria. *Afr J Microbiol Res* 4:309–313
- Katsoyiannis A, Anda EE, Cincinelli A, Martellini T, Leva P, Goetsch A, Sandanger TM, Huber S (2014) Indoor air characterization of various microenvironments in the arctic: the case of Tromsø, Norway. *Environ Res* 134:1–7. <https://doi.org/10.1016/j.envres.2014.06.011>
- Klein F, Platt SM, Farren NJ, Detournay A, Bruns EA, Bozzetti C, Daellenbach KR, Kilic D, Kumar NK, Pieber SM, Slowik JG, Temime-Roussel B, Marchand N, Hamilton JF, Baltensperger U, Prévôt ASH, el Haddad I (2016) Characterization of gas-phase organics using proton transfer reaction time-of-flight mass spectrometry: cooking emissions. *Environ Sci Technol* 50:1243–1250. <https://doi.org/10.1021/acs.est.5b04618>
- Klenø J, Wolkoff P (2004) Changes in eye blink frequency as a measure of trigeminal stimulation by exposure to limonene oxidation products, isoprene oxidation products and nitrate radicals. *Int Arch Occup Environ Health* 77:235–243. <https://doi.org/10.1007/s00420-003-0502-1>
- Król S, Namieśnik J, Zabiegała B (2014) ??-Pinene, 3-carene and d-limonene in indoor air of Polish apartments: the impact on air quality and human exposure. *Sci Total Environ* 468–469:985–995. <https://doi.org/10.1016/j.scitotenv.2013.08.099>
- Lakey PSJ, Wisthaler A, Berkemeier T, Mikoviny T, Pöschl U, Shiraiwa M (2017) Chemical kinetics of multiphase reactions between ozone and human skin lipids: implications for indoor air quality and health effects. *Indoor Air* 27:816–828. <https://doi.org/10.1111/ina.12360>
- Larroque V, Desauziers V, Mocho P (2006) Development of a solid phase microextraction (SPME) method for the sampling of VOC traces in indoor air. *J Environ Monit* 8:106–111. <https://doi.org/10.1039/B511201J>
- Liu Y, Misztal PK, Xiong J, Tian Y, Arata C, Weber RJ, Nazaroff WW, Goldstein AH (2019) Characterizing sources and emissions of volatile organic compounds in a northern California residence using space- and time-resolved measurements. *Indoor Air* 29:630–644. <https://doi.org/10.1111/ina.12562>
- Marina AM, Man YBC, Amin I (2009) Virgin coconut oil: emerging functional food oil. *Trends Food Sci Technol* 20:481–487. <https://doi.org/10.1016/j.tifs.2009.06.003>
- Markowicz P, Larsson L (2015) Influence of relative humidity on VOC concentrations in indoor air. *Environ Sci Pollut Res* 22:5772–5779. <https://doi.org/10.1007/s11356-014-3678-x>
- Mickaël D, Bruno B, Valérie C et al (2014) Indoor air quality and comfort in seven newly built, energy-efficient houses in France. *Build Environ* 72:173–187. <https://doi.org/10.1016/j.buildenv.2013.10.017>
- Nazaroff WW, Weschler CJ (2004) Cleaning products and air fresheners: exposure to primary and secondary air pollutants. *Atmos Environ* 38:2841–2865
- Nematollahi N, Kolev SD, Steinemann A (2018) Volatile chemical emissions from essential oils. *Air Qual Atmos Health* 11:949–954. <https://doi.org/10.1007/s11869-018-0606-0>
- NHMRC (1993) Volatile organic compounds in indoor air. Report of 11th session. Canberra, Australia
- Njoroge SM, Koaze H, Karanja NP, Sawamura M (2005) Volatile constituents of redblush grapefruit (*Citrus paradisi*) and pummelo (*Citrus grandis*) peel essential oils from Kenya. *J Agric Food Chem* 53:9790–9794. <https://doi.org/10.1021/jf051373s>
- Nøjgaard JK, Christensen KB, Wolkoff P (2005) The effect on human eye blink frequency of exposure to limonene oxidation products and methacrolein. *Toxicol Lett* 156:241–251. <https://doi.org/10.1016/j.toxlet.2004.11.013>
- Pegas PN, Alves CA, Evtyugina MG, Nunes T, Cerqueira M, Franchi M, Pio CA, Almeida SM, Freitas MC (2011) Indoor air quality in elementary schools of Lisbon in spring. *Environ Geochem Health* 33:455–468. <https://doi.org/10.1007/s10653-010-9345-3>
- Petr P, Soukupová A (2017) Terpenes in forest air—health benefit and healing potential. *Acta Salus Vitae* 4:61–69
- Pope CA, Dockery DW (2006) Health effects of fine particulate air pollution: lines that connect. *J Air Waste Manage Assoc* 56:709–742. <https://doi.org/10.1080/10473289.2006.10464485>
- Ramos TD, de la Guardia M, Pastor A, Esteve-Turrillas FA (2018) Assessment of air passive sampling uptakes for volatile organic

- compounds using VERAM devices. *Sci Total Environ* 619–620: 1014–1021. <https://doi.org/10.1016/j.scitotenv.2017.11.173>
- Régimbal J, Collin G (1994) Essential oil analysis of balsam fir *Abies balsamea* (L.) Mill. *J Essential Oil Res* 6:229–238. <https://doi.org/10.1080/10412905.1994.9698369>
- Rösch C, Wissenbach DK, Franck U, Wendisch M, Schlink U (2017) Degradation of indoor limonene by outdoor ozone: a cascade of secondary organic aerosols. *Environ Pollut* 226:463–472. <https://doi.org/10.1016/j.envpol.2017.04.030>
- Rumchev K, Brown H, Spickett J (2007) Volatile organic compounds: do they present a risk to our health? *Rev Environ Health* 22:39–55. <https://doi.org/10.1515/REVEH.2007.22.1.39>
- Samet JM (1993) Indoor air pollution: a public health perspective. *Indoor Air* 3:219–226. <https://doi.org/10.1111/j.1600-0668.1993.00002.x>
- Sanjuán-Herráez D, de la Osa S, Pastor A, De La Guardia M (2014) Air monitoring of selected volatile organic compounds in wineries using passive sampling and headspace-gas chromatography-mass spectrometry. *Microchem J* 114:42–47. <https://doi.org/10.1016/j.microc.2013.11.017>
- Schlink U, Röder S, Kohajda T, Wissenbach DK, Franck U, Lehmann I (2016) A framework to interpret passively sampled indoor-air VOC concentrations in health studies. *Build Environ* 105:198–209. <https://doi.org/10.1016/j.buildenv.2016.05.033>
- Seifert B (1990) Indoor air '90. In: Walkinshaw D (ed) Proceedings of the 5th international conference on indoor air quality and climate, Toronto, p 35
- Sharopov FS, Zhang H, Setzer WN (2014) Composition of geranium (*Pelargonium graveolens*) essential oil from Tajikistan. *Am J Essent Oils Nat Prod* 2:13–16
- SIS (2019) Tenax® TA breakthrough volume data. In: Tenax® TA Breakthr. Vol. Data (Accessed 13.02.2020). <https://www.sisweb.com/index/referenc/tenaxta.htm>
- Sofuoglu SC, Aslan G, Inal F, Sofuoglu A (2011) An assessment of indoor air concentrations and health risks of volatile organic compounds in three primary schools. *Int J Hyg Environ Health* 214:36–46. <https://doi.org/10.1016/j.ijheh.2010.08.008>
- Sotelo Mendez AH, Figueroa Cornejo CG, Césare Coral MF, Alegría Arnedo MC (2017) Chemical composition, antimicrobial and antioxidant activities of the essential oil of *Bursera graveolens* (Burseraceae) from Perú. *Indian J Pharm Educ Res* 51:S429–S436. <https://doi.org/10.5530/ijper.51.3s.62>
- Spengler JD, Koutrakis P, Dockery DW, Raizenne M, Speizer FE (1996) Health effects of acid aerosols on North American children: air pollution exposures. *Environ Health Perspect* 104:492–499
- Stashenko EE, Prada NQ, Martinez JR (1996) HRGC/FID/NPD and HRGC/MSD study of Colombian ylang-ylang (*Cananga odorata*) oils obtained by different extraction techniques. *J High Resolut Chromatogr* 19:353–358
- Su HJ, Chao CJ, Chang HY, Wu PC (2007) The effects of evaporating essential oils on indoor air quality. *Atmos Environ* 41:1230–1236. <https://doi.org/10.1016/j.atmosenv.2006.09.044>
- Sunil VR, Laumbach RJ, Patel KJ et al (2007) Pulmonary effects of inhaled limonene ozone reaction products in elderly rats. *Toxicol Appl Pharmacol* 222:211–220. <https://doi.org/10.1016/j.taap.2007.05.003>
- Tanaka-Kagawa T, Uchiyama S, Matsushima E et al (2005) Survey of volatile organic compounds found in indoor and outdoor air samples from Japan. *Bull Natl Inst Health Sci*:27–31
- Tao N, Liu Y, Zhang M (2009) Chemical composition and antimicrobial activities of essential oil from the peel of bingtang sweet orange (*Citrus sinensis* Osbeck). *Int J Food Sci Technol* 44:1281–1285. <https://doi.org/10.1111/j.1365-2621.2009.01947.x>
- Tsigionia A, Lagoudi A, Chandrinou S, Linos A, Evlogias N, Alexopoulos EC (2010) Indoor air in beauty salons and occupational health exposure of cosmetologists to chemical substances. *Int J Environ Res Public Health* 7:314–324. <https://doi.org/10.3390/ijerph7010314>
- Ulusoy S, Bosgelmez-Tinaz G, Secilmis-Canbay H (2009) Tocopherol, carotene, phenolic contents and antibacterial properties of rose essential oil, hydrosol and absolute. *Curr Microbiol* 59:554–558. <https://doi.org/10.1007/s00284-009-9475-y>
- USA-EPA (1996) Indoor air quality updates 9 and 10:8
- Uysal B, Sozmen F, Aktas O, Oksal BS, Kose EO (2011) Essential oil composition and antibacterial activity of the grapefruit (*Citrus paradisi* L.) peel essential oils obtained by solvent-free microwave extraction: comparison with hydrodistillation. *Int J Food Sci Technol* 46:1455–1461. <https://doi.org/10.1111/j.1365-2621.2011.02640.x>
- Verzera A, Trozzi A, Dugo G, di Bella G, Cotroneo A (2004) Biological lemon and sweet orange essential oil composition. *Flavour Fragr J* 19:544–548. <https://doi.org/10.1002/ffj.1348>
- Villanueva F, Tapia A, Amo-Salas M, Notario A, Cabañas B, Martínez E (2015) Levels and sources of volatile organic compounds including carbonyls in indoor air of homes of Puertollano, the most industrialized city in Central Iberian Peninsula. Estimation of health risk. *Int J Hyg Environ Health* 218:522–534. <https://doi.org/10.1016/j.ijheh.2015.05.004>
- Walgraeve C, Demeestere K, Dewulf J, van Huffel K, van Langenhove H (2011) Diffusive sampling of 25 volatile organic compounds in indoor air: uptake rate determination and application in Flemish homes for the elderly. *Atmos Environ* 45:5828–5836. <https://doi.org/10.1016/j.atmosenv.2011.07.007>
- Weschler CJ (2000) Ozone in indoor environments: concentration and chemistry. *Indoor Air* 10:269–288. <https://doi.org/10.1034/j.1600-0668.2000.010004269.x>
- Weschler CJ, Carlsaw N (2018) Indoor chemistry. *Environ Sci Technol* 52:2419–2428. <https://doi.org/10.1021/acs.est.7b06387>
- Wolkoff P, Clausen P, Wilkins C, Nielsen G (2000) Formation of strong airway irritants in terpene/ozone mixtures. *Indoor Air* 10:82–91. <https://doi.org/10.1034/j.1600-0668.2000.010002082.x>
- Wolkoff P, Clausen PA, Larsen K, Hammer M, Larsen ST, Nielsen GD (2008) Acute airway effects of ozone-initiated d-limonene chemistry: importance of gaseous products. *Toxicol Lett* 181:171–176. <https://doi.org/10.1016/j.toxlet.2008.07.018>
- Wolkoff P, Clausen PA, Larsen ST, Hammer M, Nielsen GD (2012) Airway effects of repeated exposures to ozone-initiated limonene oxidation products as model of indoor air mixtures. *Toxicol Lett* 209:166–172. <https://doi.org/10.1016/j.toxlet.2011.12.008>
- Yeh HC, Cuddihy RG, Phalen RF, Chang IY (1996) Comparisons of calculated respiratory tract deposition of particles based on the proposed NCRP model and the new ICRP66 model. *Aerosol Sci Technol* 25:134–140. <https://doi.org/10.1080/02786829608965386>

Publisher's note Springer Nature remains neutral with regard to jurisdictional claims in published maps and institutional affiliations.